

# VERSATILE CLASSIC SERIES PICTURE LIGHT (ALEDV)

## INSTALLATION INSTRUCTIONS

Rev. 1 (10/16)

### WARNING

Make sure the light toggle switch is in the OFF position (i.e, facing to the left, toward the light) before plugging in the light to the wall outlet. Use the toggle switch on the lighting fixture or a properly installed wall switch to toggle the picture light ON and OFF. Plugging and unplugging the power adapter to toggle the lamp ON and OFF can drastically reduce the life of the power adapter and may cause it to malfunction.

Congratulations on purchasing your new quality lighting fixture from Cocoweb. If you have any questions about these instructions or are missing any parts, please call us at 888-783-0378 or email [customerservice@cocoweb.com](mailto:customerservice@cocoweb.com).

### COCOWEB LIMITED WARRANTY:

Cocoweb.com warrants its products to be made of first class materials, free from defects of material or workmanship under normal use and to perform the service for which they are intended in a reliable and efficient manner when properly installed, for a period of (2) years from the date of purchase. During the warranty period, Cocoweb.com will, at its choice, repair or replace any part or parts which prove to be defective if returned to Cocoweb.com. NOTE: Modification of picture light in any way will void the warranty.

### CARE INSTRUCTIONS:

Wipe clean with a dry microfiber cloth. DO NOT use abrasive or chemical cleaners as they may damage the finish. Do not submerge or expose to water.

### MOUNTING BRACKET ASSEMBLY CONTENTS:

Mounting Brackets

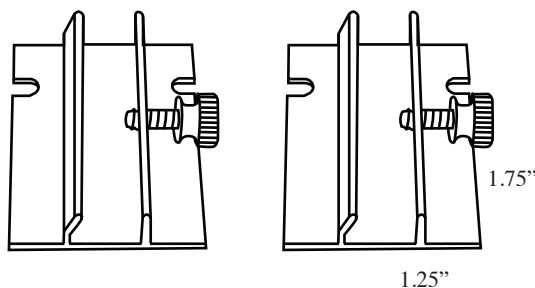

Plastic Expansion Anchors

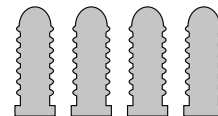

1" Screws

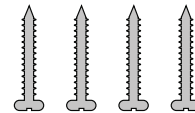

3/8" Screw Bumpers

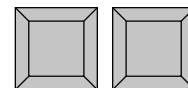

### CAUTION

Please read this entire manual before installation and use of fixture.  
IMPORTANT - Save these instructions for later use.

# VERSATILE CLASSIC SERIES PICTURE LIGHT (ALEDV)

## WALL MOUNTED INSTALLATION

### WARNING

Make sure the light toggle switch is in the OFF position (i.e, facing to the left, toward the light) before plugging in the light to the wall outlet. Use the toggle switch on the lighting fixture or a properly installed wall switch to toggle the picture light ON and OFF. Plugging and unplugging the power adapter to toggle the lamp ON and OFF can drastically reduce the life of the power adapter and may cause it to malfunction.

### STEP 1: UNPACKING THE LIGHT:

1. Remove foam and plastic wrapping from the light fixture.
2. Rotate arms so they are perpendicular to the shade tube.

### STEP 2: BRACKET INSTALLATION ON THE WALL:

#### A. FOR DRYWALL:

1. On the wall, mark an X where the center of the frame will be located.
2. On the wall, mark a small line where the top of the frame will be.

**NOTE:** The top of the mounting bracket should be aligned horizontally 1" below the edge of the frame, or in a position where they will remain hidden behind the frame when installed.

3. Measure the distance from the center mark outward and mark the location for the mounting bracket "outer screws." Refer to the chart to the right for measurements.

**NOTE:** It is recommended that you do your own measurements for the best results.

4. Using the mounting bracket as a guide, mark the "inner screw" position for both sides, making sure that the mounting bracket holes are aligned and in a level position.
5. If you are drilling into a wood stud, skip to STEP 8, as you do not need to install a plastic expansion anchor. If you are NOT drilling into a wood stud, drill four holes in the previously marked areas with a 1/4" drill bit, making sure the plastic expansion anchor will be able to fit snugly.

**NOTE:** Do not drill the hole too big. This will cause the plastic expansion anchor to fall through the hole when screwing in screws.

6. Gently tap the plastic expansion anchors with a hammer or rubber mallet into each of the holes, making sure they are flush against the wall.
7. Mount the brackets, with the thumbscrew located on the rightside, by screwing a 1" screw through the mounting bracket openings into the plastic expansion anchors. If installing on a wood stud, screw the 1" screws through the mounting bracket opening directly into the wall.

SKU	center to outer
ALEDV14	5"
ALEDV24	12"
ALEDV36	20"
ALEDV41	20"

#### B. FOR WOOD WALLS :

1. Follow STEP 1-5 of drywall installation instructions.
2. Skip to STEP 8 and use 3/8" screws instead of 1" screws.

**NOTE:** You do not have to use plastic expansion anchors for wood walls.

### STEP 3: LIGHT FIXTURE INSTALLATION:

1. Unscrew the thumb screws to insert the light fixture arms into the mounting brackets.
2. Slide the arms up or down to attain the desired shade location in relation to the frame. For best results, align the shade parallel to or slightly below the top of the frame. You may usually position the light by "eyeballing" the shade tube in relation to the top of the frame. Adjust and tighten the thumb screws into position.
3. You may adjust the light spread on the artwork by loosening the rotation adjustment screws and rotating the shade.

**NOTE:** To avoid discomfort, protect your hands with a glove or piece of cloth if you rotate the tube while the picture light is turned on.

4. Install the two plastic "bumpers" on the two bottom corners of the frame. This will protect your wall from scratching.

# VERSATILE CLASSIC SERIES PICTURE LIGHT (ALEDV)

## FRAME MOUNTED INSTALLATION

### WARNING

Make sure the light toggle switch is in the OFF position (i.e, facing to the left, toward the light) before plugging in the light to the wall outlet. Use the toggle switch on the lighting fixture or a properly installed wall switch to toggle the picture light ON and OFF. Plugging and unplugging the power adapter to toggle the lamp ON and OFF can drastically reduce the life of the power adapter and may cause it to malfunction.

### STEP 1: UNPACKING THE LIGHT:

1. Remove all plastic wrapping from the light fixture.
2. Rotate the arms so they are perpendicular to the shade tube.

### STEP 2: BRACKET INSTALLATION ON THE FRAME:

1. Place frame upside down on a table with the top toward you and positioned at the edge of the table.
2. Mark the center of the frame with a pencil or magic marker.
3. Next, mark the location for the mounting bracket "outer" screws. See chart at right for lamp length and distance needed from outside screw position to center of frame.
4. For wood frame installation, attach the mounting brackets using the small 3/8" screws.
5. For metal frame installation, install the mounting brackets using the channel brackets provided:
  - a. Start screw in channel bracket.
  - b. Insert channel bracket into frame channel.
  - c. Slide screw in channel bracket into slot in mounting bracket slot.
  - d. Locate bracket according to #3 above.
  - e. Tighten Screw
  - f. Install another channel bracket on the other side of the mounting bracket.

SKU	center to outer
ALEDV14	5"
ALEDV24	12"
ALEDV36	20"
ALEDV41	20"

### STEP 3: LIGHT FIXTURE INSTALLATION INSTRUCTIONS:

1. Unscrew the thumb screws to insert the light fixture arms into the mounting brackets.
  2. Slide the arms up or down to attain the desired shade location in relation to the frame. For best results, align the shade parallel to or slightly below the top of the frame. You may usually position the light by "eyeballing" the shade tube in relation to the top of the frame. Adjust and tighten the thumb screws into position.
  3. You may adjust the light spread on the artwork by loosening the rotation adjustment screws and rotating the shade.
- NOTE:** To avoid discomfort, protect your hands with a glove or piece of cloth if you rotate the tube while the picture light is turned on.
4. Install the two plastic "bumpers" on the two bottom corners of the frame. This will protect your wall from scratching.

# VERSATILE CLASSIC SERIES PICTURE LIGHT (ALEDV)

## SETUP INSTRUCTIONS

### WARNING

Make sure the light toggle switch is in the OFF position (i.e, facing to the left, toward the light) before plugging in the light to the wall outlet. Use the toggle switch on the lighting fixture or a properly installed wall switch to toggle the picture light ON and OFF. Plugging and unplugging the power adapter to toggle the lamp ON and OFF can drastically reduce the life of the power adapter and may cause it to malfunction.

### STEP 1: CONNECTING THE LIGHT:

1. Once the light is properly installed to your desired location, insert the connector on the wall adapter into the bottom of the picture light arm.
2. Make sure the toggle switch is set to the OFF position (to the left).
3. Plug the adapter into the wall outlet.
4. Switch the toggle switch on the lamp to the ON position (to the right) and verify the the light turns on.

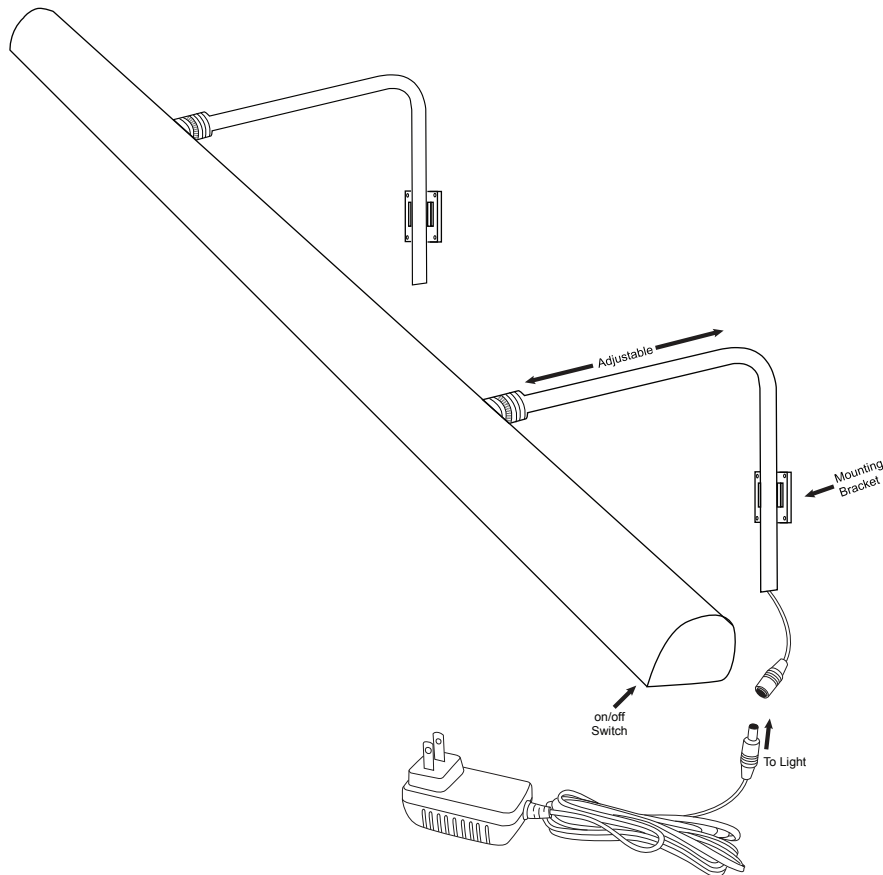

### POWER SPECIFICATIONS

INPUT : 100-240V~ 50/60Hz 0.4A Max
OUTPUT : 6V 1500mA