

BATTERY OPERATED LED CLASSIC PICTURE LIGHT (BAL10/14)  
INSTALLATION INSTRUCTIONS

Rev. 2 (05/15)

Congratulations on purchasing your new quality lighting fixture from Cocoweb.com. If you have any questions about these instructions or are missing any parts, please call us at 888-783-0378 or email us at customerservice@cocoweb.com.

SPECIFICATIONS:

- Pre-installed natural light LED array
- LED lifespan: 50,000 hours
- Battery operated (4 C-Cell batteries)
- Wireless remote operated
- Color temperature: 2700k
- UV and Infrared-free LED technology

IMPORTANT SAFETY INSTRUCTIONS:

- Do not place near any extreme heat or in direct sunlight.
- Place on an even and secure surface.
- Keep the lamp dry and clean.
- For use in indoor dry rooms only. Not suitable for damp rooms.
- Do not look directly into the light source.

CARE INSTRUCTIONS:

DO NOT use abrasive or chemical cleaners to clean the picture light as it may damage the finish. Use only warm water, then wipe dry with a clean soft cloth.

LED ARRAY REPLACEMENT:

The LED array is rated to last 50,000 hours. Should the LED bulbs cease to function in the warranty period, Cocoweb.com will replace the LED array free of charge. Cocoweb.com may at its choice, send either a replacement LED array directly or request for the whole lamp to be shipped to a Cocoweb.com location or authorized dealer. Shipping and handling charges may be incurred. After the 2 year warranty period, you may purchase a replacement LED array by contacting Cocoweb.com customer service.

TROUBLESHOOTING AND REPAIR:

Should the lamp stop working properly and/or one of the following problems occur: (1) The lamp fails to turn on (2) The lamp flickers (3) The lamp dims to an unusual level, turn the lamp off using the remote, re-check that all batteries are inserted properly or if they are in need of replacement, then turn the lamp back on. If the problem persists, discontinue use of lamp and contact Cocoweb.com customer service.

COCOWEB LIMITED WARRANTY:

Cocoweb.com warrants its picture lights to be made of first class materials, free from defects of material or workmanship under normal use and to perform the service for which they are intended in a reliable and efficient manner when properly installed, for a period of 2 years from the date of purchase. During the warranty period, Cocoweb.com will, at its choice, repair or replace any part or parts which prove to be defective if returned to Cocoweb.com. NOTE: Modification of the picture light in any way will void the warranty.

CAUTION

Please read this entire manual before installation and use of fixture.  
IMPORTANT - Save these instructions for later use.



Danger of suffocation  
Keep children away from packaging

**BATTERY OPERATED LED CLASSIC PICTURE LIGHT (BAL10/14)**  
**INSTALLATION INSTRUCTIONS**

**STEP 1: UNPACKING THE LIGHT:**

1. Remove all plastic wrapping from the light fixture.

**FRAME INSTALLATION:**

1. Place frame upside down on a table with the top toward you and positioned at the edge of the table.  
2. Remove base cover on lamp by removing the screw on each side of the base.  
3. Attach the lamp to the frame using the small 3/8” screws included.  
4. Once the lamp is mounted, place four (4) C-Cell batteries (not included) in the lamp base.  
5. Re-insert the base cover removed in step 2, then tighten the screws on the base.

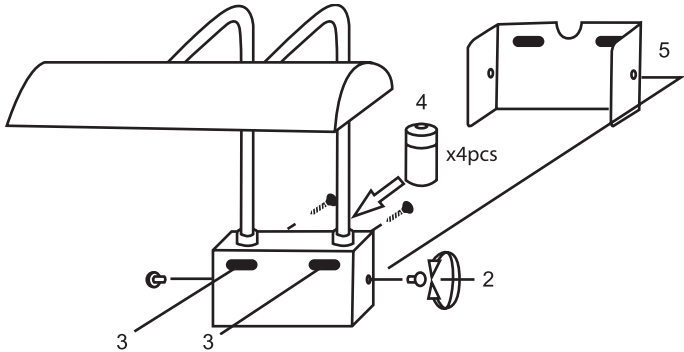

**WALL INSTALLATION:**

1. Remove base cover on lamp by removing the screw on each side of the base.  
2. Attach the removed base cover to the wall using the provided screws and anchors.  
3. Once the base is mounted, place four (4) C-Cell batteries (not included) in the lamp base.  
4. Carefully place the lamp over the mounted cover, and attach by replacing the screws removed in step 1.

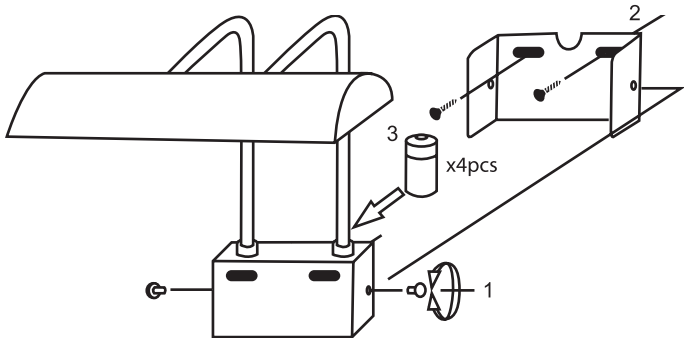

**Caution** Make sure the batteries are installed properly to avoid damage

**Caution** Make sure all wires are properly enclosed within the base panel when installing cover to avoid damage.

Please refer to the “Remote Control User Manual” to setup the wireless remote.

**BATTERY OPERATED LED CLASSIC PICTURE LIGHT (BAL10/14)**  
**REMOTE CONTROL USER MANUAL**

**IMPORTANT**

For best operation, use this remote within 30 feet of the receiver. The remote will automatically go into a sleep mode after 8 seconds of inactivity. Press the POWER button or the + / - key to deactivate sleep mode.

**CONNECTING YOUR REMOTE TO THE PICTURE LIGHT**

**Step 1:** Remove the cover on the back of the remote and install the included 12V battery.

**Step 2:** Within 30 seconds of installing the batteries in the picture light, press and hold the **learn button** for 10 seconds, located in the covered area on the underside of the remote. Once the picture light has learned the ID code, the picture light will power off momentarily and then flash three times. This will indicate the remote has been successfully paired.

**\*If step 2 is not finished within 30 seconds, the learning process will not be successful, and must be restarted by removing the batteries in the picture light.**

**REMOTE FUNCTIONS**

**⏻ POWER BUTTON:** Turn the light ON/OFF.

**+ BRIGHTNESS UP:** Press and hold to slowly increase the brightness up to 100%

**— BRIGHTNESS DOWN:** Press and hold to slowly reduce the brightness down to 10%.

**1 ONE HOUR TIMER:** The picture light will increase or decrease in brightness by 30%, depending on current setting, then will gradually change back to default level, and automatically turn off after 1 hour.

**2 TWO HOUR TIMER:** The picture light will increase or decrease in brightness by 30%, depending on current setting, then will gradually change back to default level, and automatically turn off after 2 hours.

**3 THREE HOUR TIMER:** The picture light will increase or decrease in brightness by 30%, depending on current setting, then will gradually change back to default level, and automatically turn off after 3 hours.

**6 SIX HOUR TIMER:** The picture light will increase or decrease in brightness by 30%, depending on current setting, then will gradually change back to default level, and automatically turn off after 6 hours.